



**Hemstal Road, West Hampstead, London NW6**

**Subject To Contract £499,000 | Leasehold**

Contact us about this property

337 West End Lane, West Hampstead, London, NW6 1RS

E: [nw6@alexanders-uk.com](mailto:nw6@alexanders-uk.com)

T: 0207 431 0666

[www.alexanders-uk.com](http://www.alexanders-uk.com)

# Alexanders

Property Consultants

---



## About This Property

A spacious one bedroom apartment situated on the raised ground floor of this Victorian conversion. Presented in fantastic condition throughout with a large bright reception and separate kitchen. Double bedroom with plenty of storage and large bathroom.

The property is situated on a quiet tree-lined street just 0.1 miles away from the West Hampstead tube, Overground and Thameslink, and a plethora of trendy cafés and restaurants.



# Alexanders

Property Consultants

 1 Bedroom |  1 Reception |  1 Bathroom |  null

## Property Features

- Raised Ground Floor Flat
- One Double Bedroom
- 5 minute walk to West Hampstead Underground
- 7 minute walk to West Hampstead Overground
- 7 minute walk to West Hampstead Thameslink

## Property Size

514.00 sq ft

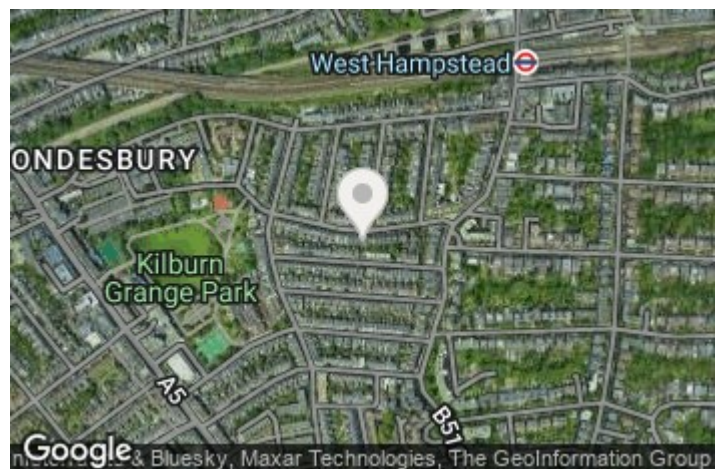
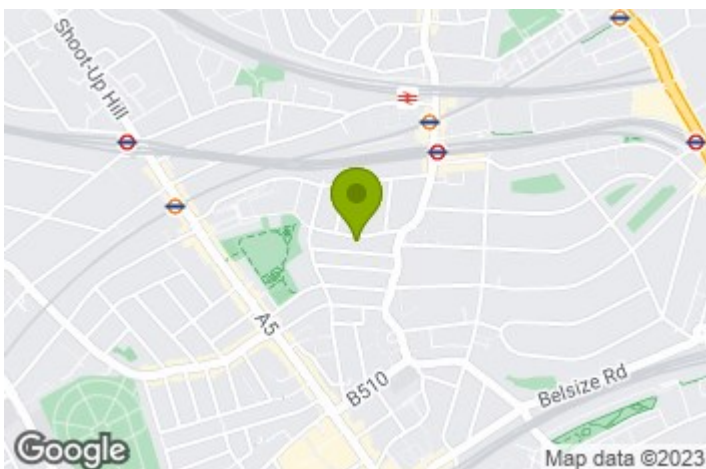

## Nearest Transport Links

# Alexanders

Property Consultants

Hemstal Road, NW6

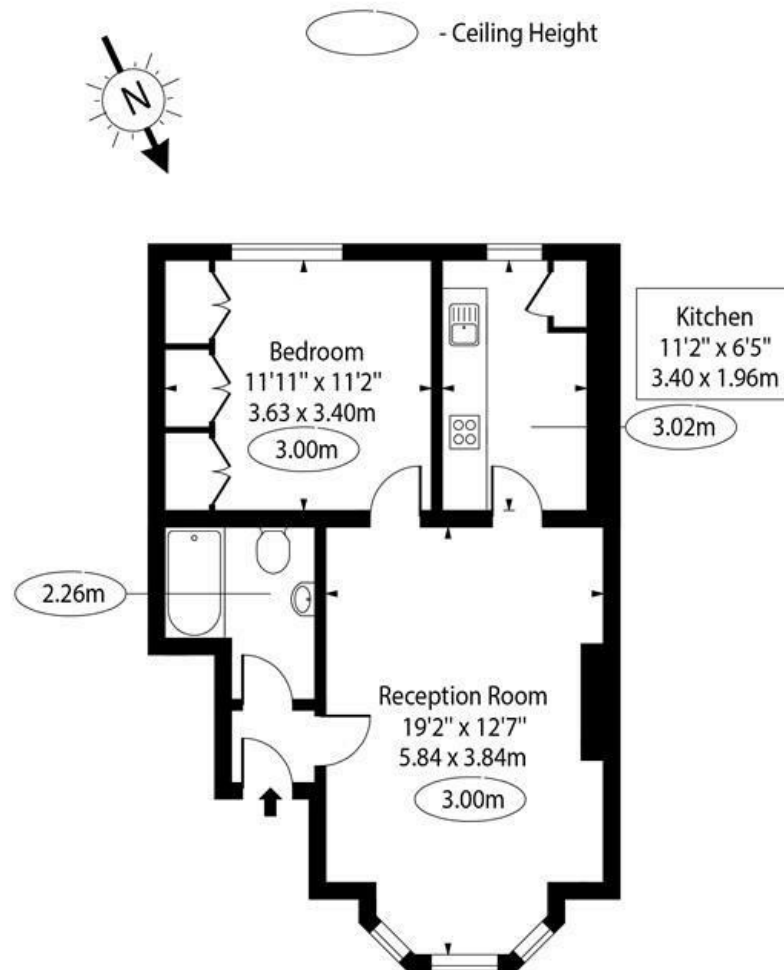

First Floor

Approx Gross Internal Area 514 Sq Ft - 47.75 Sq M

For Illustration Purposes Only - Not To Scale Floor Plan by [www.nogaphotostudio.com](http://www.nogaphotostudio.com) Ref: No.47530

This floor plan should be used as a general outline for guidance only. Any intending purchaser or lessee should satisfy themselves by inspection, searches, enquiries and full survey as to the correctness of each statement. Any areas, measurements or distances quoted are approximate and should not be used to value a property or be the basis of any sale or let.

Contact us about this property

337 West End Lane, West Hampstead, London, NW6 1RS

E: [nw6@alexanders-uk.com](mailto:nw6@alexanders-uk.com)

T: 0207 431 0666

[www.alexanders-uk.com](http://www.alexanders-uk.com)